



®

**CORPORATION**

# **SEDIMENT TRAP**

MODEL 8330

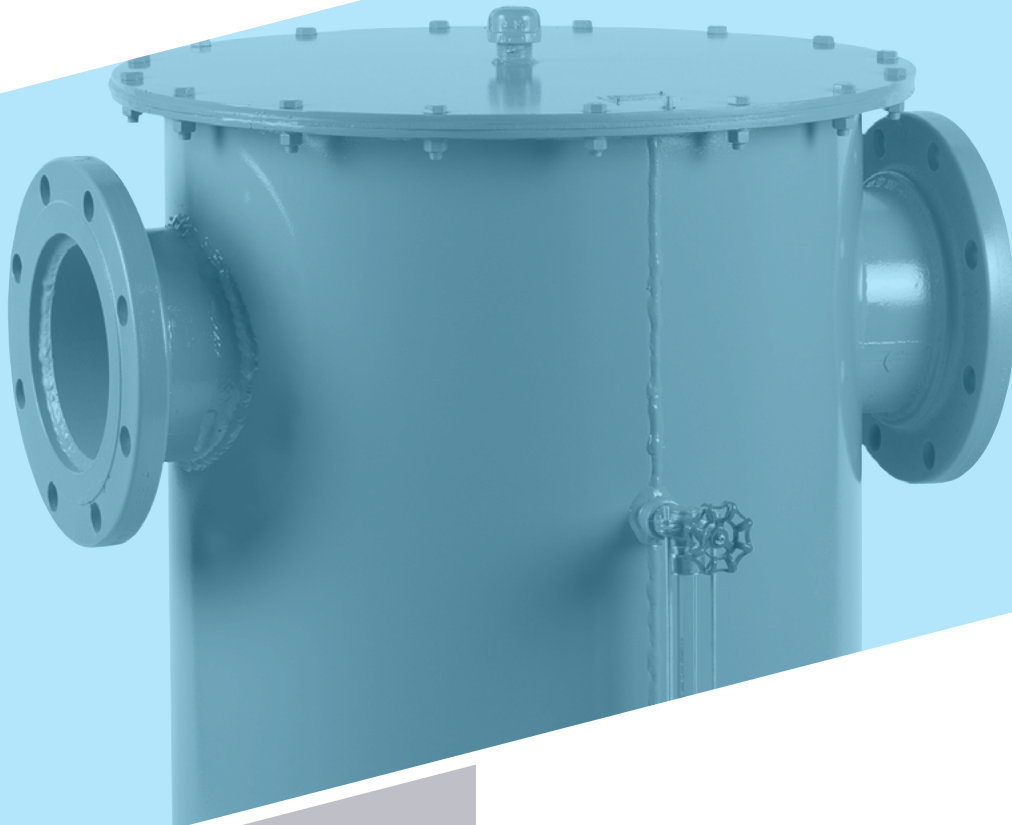

# MODEL 8330

The Groth Model 8330 Sediment Trap is for use in low pressure gas lines to remove sediment and/or condensate from “wet” gas. These traps are normally installed to provide additional safety by removing almost all of the solids and liquids from the gas stream. Groth’s design creates a combination of internal centrifugal force and a drop in gas velocity to successfully remove liquids and solids.

## Technical Details

- Sizes: 2” (DN50) to 12” (DN300)
- Materials: Carbon Steel, Stainless Steel, special materials available upon request
- Capacity 12 gallons minimum
- Pressure: rated to 5 psig, up to 25 psig available

## Options

- Hot-dip galvanization
- Insulated jacket
- Stainless steel hand valves
- Wire mesh strainer
- Inspection port



# SPECIFICATIONS

Size 150# ASME Inches (mm)	A Length Inches (mm)	B Height Inches (mm)	C Width Inches (mm)	D Connection Height Inches (mm)	Approx Ship. Weight Lbs. (kg)
2 (50)	27 (685)	33.75 (857)	23 (584)	25 (635)	200 (91)
3 (80)	27 (685)	33.75 (857)	23 (584)	25 (635)	210 (95)
4 (100)	27 (685)	33.75 (857)	23 (584)	25 (635)	220 (100)
6 (150)	27 (685)	33.75 (857)	23 (584)	25 (635)	275 (125)
8 (200)	38 (965)	35.75 (908)	33 (838)	25 (635)	375 (170)
10 (250)	38 (965)	35.75 (908)	33 (838)	25 (635)	395 (180)
12 (300)	38 (965)	35.75 (908)	33 (838)	25 (635)	425 (193)

Specifications subject to change without notice.  
Certified dimensions available upon request.

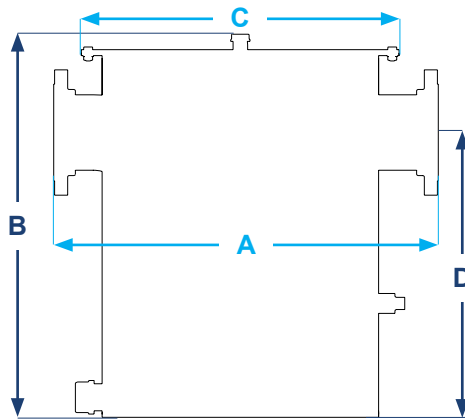

# HOW TO ORDER

For easy ordering, select proper model numbers

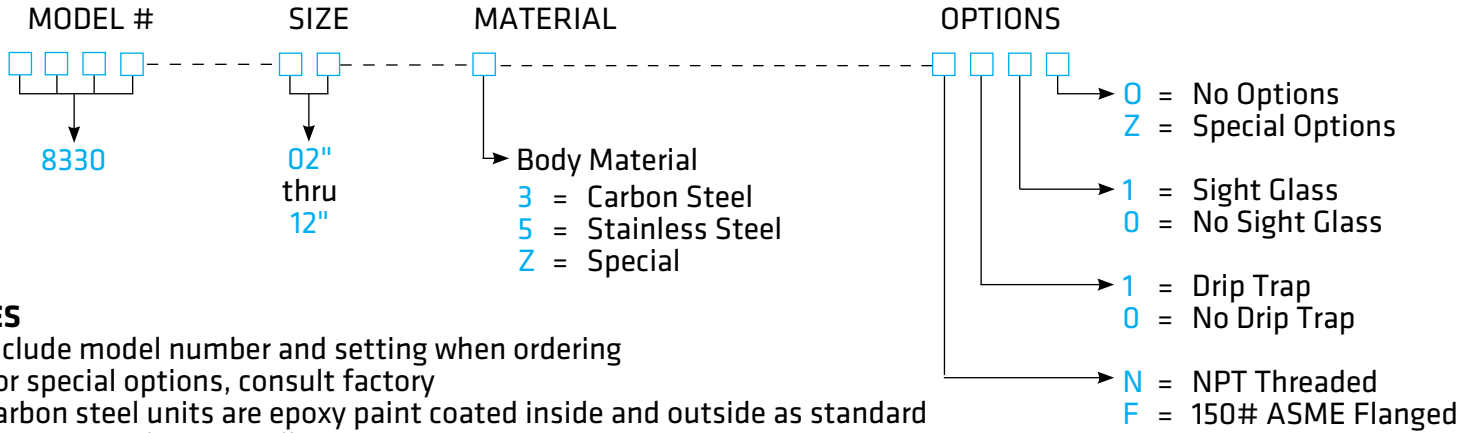

## NOTES

- Include model number and setting when ordering
- For special options, consult factory
- Carbon steel units are epoxy paint coated inside and outside as standard
- 2" - 6" sizes have 12 gallon capacity minimum.
- 8" - 12" sizes have 28 gallon capacity minimum

## EXAMPLE

8 3 3 0 — 0 2 — 3 — F 1 1 0

Indicates a 2" Model 8330 with carbon steel body, 150# ASME flange, drip trap, sight glass and no special options.



[GROTHCORP.COM](http://GROTHCORP.COM)